

March 9, 2018

Dear Sir:

Attached is Addendum No. 1 dated March 9, 2018 to the Specifications for The Manitoba Water Services Board Contract No. M.W.S.B. #1409, R.M. of St. Andrews Low-Pressure Sewer Phase 2 Collection – Contract 1. Please verify receipt of this Addendum for our records by fax to (204) 726-6290.

ACKNOWLEDGEMENT OF RECEIPT OF ALL ADDENDUMS
MUST BE INCLUDED IN THE TENDER SUBMISSION.**

Failure to include acknowledgement shall cause the tender to be rejected. If Tender is submitted before Addendum is issued, the Board will accept a faxed acknowledgement prior to the tender closing.

Yours truly,

R. Lytle
Construction Manager

The Manitoba Water Services Board
Unit #1A - 2010 Currie Blvd.
Brandon, MB R7B 4E7

Dear Sir:

We have received Addendum No. 1 dated March 9, 2018 to the Specifications for The Manitoba Water Services Board Contract No. M.W.S.B. #1409, R.M. of St. Andrews Low-Pressure Sewer Phase 2 Collection – Contract 1.

Yours truly,

Company

Per

THE MANITOBA WATER SERVICES BOARD

**Project No. MWSB 1409
R.M. of St. Andrews Low-Pressure Sewer
Phase 2 Collection – Contract 1**

ADDENDUM NO. 1 (March 9, 2018)

To the tender documents for the R.M. of St. Andrews Low-Pressure Sewer Phase 2 Collection – Contract 1.

1) **PRECEDENCE**

This addendum takes precedence over the plans and specifications, and forms an integral part of the project and is to be read in conjunction therewith.

2) **SCOPE**

- a. The test pits have been scheduled for March 16 commencing at 9am at location #1 shown on the attached map.
- b. Replace Appendix B – List of Properties Requiring Services with the attached tables.

111216680
Test Pits - March 16



Stantec Consulting Ltd.
Suite 500, 311 Porlage Avenue
Winnipeg MB Canada R3B 2B9
Tel. 204.489.5900 Fax. 204.453.9012
www.stantec.com

Copyright Reserved
The Contractor shall verify and be responsible for all dimensions.
DO NOT SCALE the drawing - any errors or omissions shall be reported
to Stantec without delay.
The Copyright in all designs and drawings are the property of Stantec.
Reproduction or use for any purpose other than that authorized by
Stantec is forbidden.

Legend

PROPOSED	LEGEND	FUTURE
150 LPS	LOW PRESSURE SEWER	150 LPS
⊙	VALVE	⊙
⊕	CLEANOUT ASSEMBLY	⊕

- Notes
- CONTRACTOR TO VERIFY LOCATION, SIZE AND TYPE OF ALL EXISTING UTILITIES PRIOR TO CONSTRUCTION AND NOTIFY ENGINEER OF ANY CONFLICTS OR DISCREPANCIES.
 - ALL LOW PRESSURE SEWER TO BE INSTALLED BY TRENCHLESS METHODS.
 - ALL SEWER SERVICE LOCATIONS TO BE CONFIRMED IN THE FIELD BY THE ENGINEER. CONTRACTOR TO ARRANGE SITE MEETING WITH EACH PROPERTY OWNER.
 - ALL HIGHWAY CROSSINGS TO BE INSTALLED PERPENDICULAR TO THE ROAD.
 - ALL SERVICES 38mm DIAMETER UNLESS OTHERWISE NOTED.
 - COMPACTED SELECT GRANULAR BACKFILL REQUIRED FOR ALL EXCAVATIONS WITHIN 2.0m OF ALL ROADS, APPROACHES, SIDEWALKS AND OTHER PAVED SURFACES.
 - ALL LOW PRESSURE SEWER TO HAVE 2.75m MINIMUM COVER EXCEPT WHERE NOTED OTHERWISE ON THE DRAWINGS.

Revision	By	Appd.	YYMMDD
5			
4			
3			
2			
1			
Issued			
File Name:	16680C-101	AM/NA	SR
		Dwn	Chkd
		Dsgn	YYMMDD

Permit-Seal

Engineers
Geoscientists
MANITOBA
Certificate of Authorization
Stantec Consulting Ltd.
No. 1301

Client/Project
THE MANITOBA WATER SERVICES BOARD

R.M. OF ST. ANDREWS LOW PRESSURE SEWER
PHASE 2 - CONTRACT 1 (MWSB #1409)
St. Andrews, MB Canada

Title
GENERAL LAYOUT

Project No.
111216680

Drawing No.
Sheet

Scale
1:7500

Revision

C-101 01 of XX

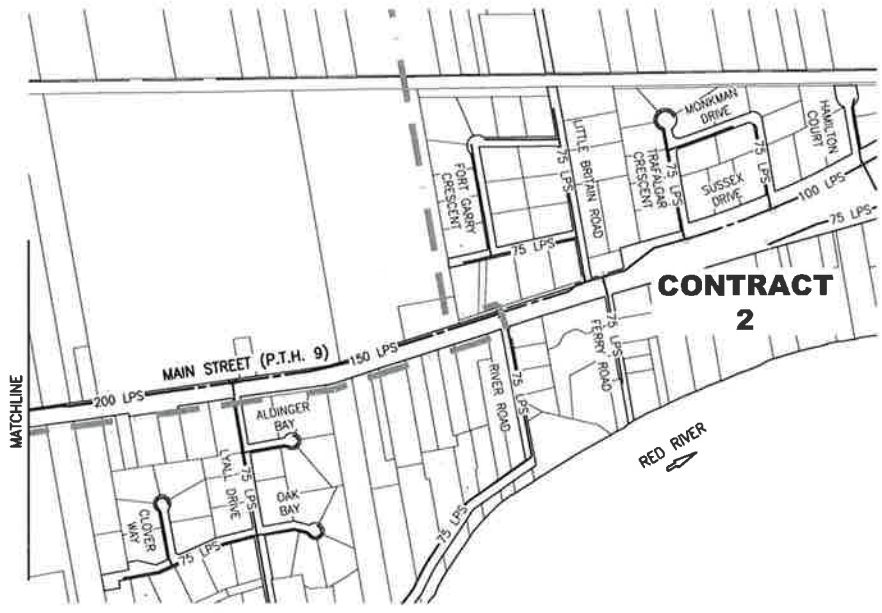
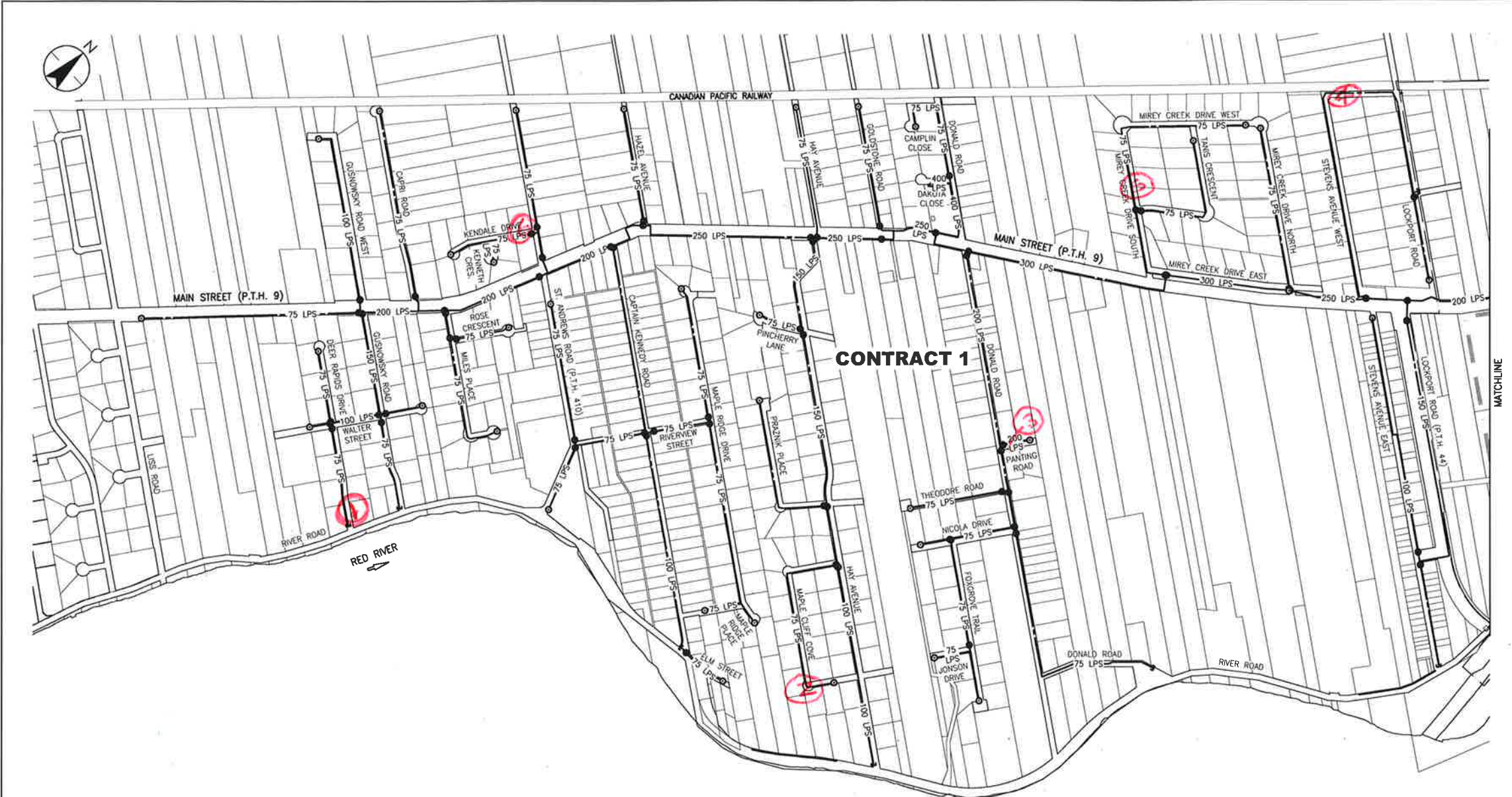

WARNING

METRIC
WHOLE NUMBERS INDICATE MILLIMETRES
DECIMALIZED NUMBERS INDICATE METRES

PRELIMINARY
NOT TO BE USED FOR CONSTRUCTION

I:\111216680\111216680_0000.dwg 11/16/2012 10:41:29 AM 111216680.dwg C:\101
 2012/04/13 10:41:29 AM 111216680.dwg C:\101

Phase 2 - Contract 1 - List of Properties Requiring Service

Property	Roll Number	Civic	Address
1	24800	5487	Highway #9 .
2	24900	5432	No. 9 Hwy W
3	25300	5491	No. 9 Hwy E
4	25400	5493	No. 9 Hwy E
5	25500	5436	No. 9 Hwy W
6	25600	5440	Hwy # 9 . W
7	26200	5497	No. 9 Hwy E
8	26300	5501	No. 9 Hwy E
9	26400	5442	No. 9 Hwy W
10	26500	5446	No. 9 Hwy
11	27000	5505	Highway #9 .
12	27100	5450	No. 9 Hwy W
13	27400	5454	No. 9 Hwy W
14	27500	5460	No. 9 Hwy W
15	27800	5525	Highway #9 .
16	27802	2	Deer Rapids Dr
17	27804	4	Deer Rapids Dr
18	27806	6	Deer Rapids Dr
19	27808	8	Deer Rapids Dr
20	27810	10	Deer Rapids Dr
21	27812	12	Deer Rapids Dr
22	27814	14	Deer Rapids Dr
23	27818	3	Deer Rapids Dr
24	27820	5	Deer Rapids Dr
25	27822	7	Deer Rapids Dr
26	27824	9	Deer Rapids Dr
27	27826	11	Deer Rapids Dr
28	27828	15	Deer Rapids Dr
29	27900	5468	No. 9 Hwy W
30	28000	5474	No. 9 Hwy W
31	28086	121	Gusnowsky Rd
32	28088	119	Gusnowsky Rd
33	28090	117	Gusnowsky Rd
34	28092	115	Gusnowsky Rd
35	28094	111	Gusnowsky Rd
36	28096	112	Gusnowsky Rd
37	28098	110	Gusnowsky Rd
38	28100	109	Gusnowsky Rd
39	28105	107	Gusnowsky Rd
40	28110	105	Gusnowsky Rd
41	28115	103	Gusnowsky Rd
42	28120	101	Gusnowsky Rd
43	28125	108	Gusnowsky Rd
44	28130	106	Gusnowsky Rd

45	28135	104 Gusnowsky Rd
46	28140	102 Gusnowsky Rd
47	28145	100 Gusnowsky Rd
48	28180	Gusnowsky Rd
49	28218	6 Gusnowsky Rd
50	28220	4 Gusnowsky Rd
51	28224	5 Gusnowsky Rd
52	28226	3 Gusnowsky Rd
53	28228	354 River Rd
54	28250	15 Gusnowsky Rd
55	28255	13 Gusnowsky Rd
56	28260	11 Gusnowsky Rd
57	28265	9 Gusnowsky Rd
58	28270	7 Gusnowsky Rd
59	28275	8 Gusnowsky Rd
60	28280	10 Gusnowsky Rd
61	28285	12 Gusnowsky Rd
62	28290	14 Gusnowsky Rd
63	28295	16 Gusnowsky Rd
64	28300	350 River Rd
65	28500	61 Walter St
66	28530	No. 9 Hwy
67	28535	60 Walter St
68	28540	5539 No. 9 Hwy E
69	28545	62 Walter St
70	28555	63 Walter St
71	28610	2 Capri Rd
72	28620	14 Capri Rd
73	28625	12 Capri Rd
74	28630	10 Capri Rd
75	28635	8 Capri Rd
76	28640	6 Capri Rd
77	28645	4 Capri Rd
78	28655	3 Capri Rd
79	28660	5 Capri Rd
80	28665	7 Capri Rd
81	29300	118 St Andrews Rd
82	29310	25 Capri Rd
83	29320	23 Capri Rd
84	29400	112 St Andrews Rd
85	29410	110 St. Andrews Rd
86	29420	Capri Rd
87	29430	15 Capri Rd
88	29500	2 Kendale Dr
89	29502	4 Kendale Dr
90	29504	6 Kenneth Cre
91	29506	8 Kenneth Cre

92	29508	1 Kendale Dr
93	29510	3 Kendale Dr
94	29512	5 Kendale Dr
95	29520	7 Kendale Dr
96	29525	9 Kendale Dr
97	29530	12 Kendale Dr
98	29540	5502 Hwy #9 Dr
99	29600	5565 No. 9 Hwy
100	29700	1 Rose Cre
101	29702	2 Rose Cre
102	29704	3 Rose Cre
103	29706	4 Rose Cre
104	29708	5 Rose Cre
105	29710	6 Rose Cre
106	29712	7 Miles Pl
107	29714	8 Miles Pl
108	29716	9 Miles Pl
109	29718	10 Miles Pl
110	29720	11 Miles Pl
111	29724	13 Miles Pl
112	29726	14 Miles Pl
113	29728	15 Miles Pl
114	29730	16 Miles Pl
115	29732	17 Miles Pl
116	29734	18 Miles Pl
117	29736	19 Miles Pl
118	29738	20 Miles Pl
119	29740	21 Miles Pl
120	29760	40 St Andrews Rd
121	29765	38 St Andrews Rd
122	29770	36 St Andrews Rd
123	29775	34 St Andrews Rd
124	29780	32 St Andrews Rd
125	29785	28 St Andrews Rd
126	29800	5561 No. 9 Hwy
127	30000	3 St Andrews Rd
128	30300	44 St Andrews Rd
129	30350	42 St Andrews Rd
130	30900	116 St Andrews Rd
131	30915	Capri Rd
132	31000	114 St Andrews Rd
133	31100	108 St Andrews Rd
134	31110	Capri Rd
135	31120	Capri Rd
136	33900	112 Hazel Ave
137	34180	108 Hazel Ave
138	34190	106 Hazel Ave

139	34200	104 Hazel Ave
140	34210	102 Hazel Ave
141	34300	100 Hazel Ave
142	34304	5538 No. 9 Hwy
143	34308	5534 No. 9 Hwy W
144	34310	5524 Highway #9 .
145	34312	103 St Andrews Rd
146	34314	5522 Highway #9 .
147	34360	5530 No. 9 Hwy W
148	34400	103A St Andrews Rd
149	34450	105 St Andrews Rd
150	34500	107 St Andrews Rd
151	34550	St. Andrews Rd
152	34600	115 St Andrews Rd
153	34700	113 St Andrews Rd
154	34800	111 St Andrews Rd
155	36550	70 Captain Kennedy Rd S
156	36600	5581 No. 9 Hwy E
157	36700	5577 No. 9 Hwy E
158	36800	5575 No. 9 Hwy E
159	37000	5571 No. 9 Hwy E
160	37100	68 Captain Kennedy Rd S
161	37200	66 Captain Kennedy Rd S
162	37300	64 Captain Kennedy Rd S
163	37400	62 Captain Kennedy Rd S
164	37500	60 Captain Kennedy Rd S
165	37600	58 Captain Kennedy Rd S
166	37700	56 Captain Kennedy Rd S
167	37800	54 Captain Kennedy Rd S
168	37900	52 Captain Kennedy Rd S
169	38000	50 Captain Kennedy Rd S
170	38100	48 Captain Kennedy Rd S
171	38200	46 Captain Kennedy Rd S
172	38300	44 Captain Kennedy Rd S
173	38450	39 St Andrews Rd
174	38500	37 St Andrews Rd
175	38600	35 St Andrews Rd
176	38700	33 St Andrews Rd
177	38800	31 St Andrews Rd
178	38900	29 St Andrews Rd
179	39000	27 St Andrews Rd
180	39100	25 St Andrews Rd
181	39200	23 St Andrews Rd
182	39300	21 St Andrews Rd
183	39400	19 St Andrews Rd
184	39500	17 St Andrews Rd
185	39600	6 Riverview St

186	39700	5593 No. 9 Hwy E
187	39800	
188	39900	71 Captain Kennedy Rd N
189	40000	69 Captain Kennedy Rd N
190	40100	67 Captain Kennedy Rd N
191	40200	65 Captain Kennedy Rd N
192	40300	63 Captain Kennedy Rd N
193	40400	61 Captain Kennedy Rd N
194	40500	59 Captain Kennedy Rd N
195	40600	57 Captain Kennedy Rd N
196	40700	55 Captain Kennedy Rd N
197	40800	53 Captain Kennedy Rd N
198	40900	51 Captain Kennedy Rd N
199	41000	49 Captain Kennedy Rd N
200	41100	47 Captain Kennedy Rd N
201	41200	45 Captain Kennedy Rd N
202	41300	43 Captain Kennedy Rd N
203	41400	39 Captain Kennedy Rd N
204	41500	37 Captain Kennedy Rd N
205	41600	35 Captain Kennedy Rd N
206	41700	33 Captain Kennedy Rd N
207	41800	31 Captain Kennedy Rd N
208	41900	29 Captain Kennedy Rd N
209	42000	27 Captain Kennedy Rd N
210	42100	25 Captain Kennedy Rd
211	42200	23 Captain Kennedy Rd N
212	42300	21 Captain Kennedy Rd N
213	42400	19 Captain Kennedy Rd N
214	42500	17 Captain Kennedy Rd N
215	42600	15 Captain Kennedy Rd N
216	42700	13 Captain Kennedy Rd N
217	42800	11 Captain Kennedy Rd N
218	42900	9 Captain Kennedy Rd N
219	43000	7 Captain Kennedy Rd N
220	43100	11 Riverview St
221	43200	36 Captain Kennedy Rd S
222	43300	34 Captain Kennedy Rd S
223	43400	32 Captain Kennedy Rd S
224	43500	30 Captain Kennedy Rd S
225	43600	28 Captain Kennedy Rd S
226	43700	26 Captain Kennedy Rd S
227	43800	24 Captain Kennedy Rd S
228	43900	22 Captain Kennedy Rd S
229	44000	20 Captain Kennedy Rd S
230	44100	18 Captain Kennedy Rd S
231	44200	16 Captain Kennedy Rd S
232	44300	14 Captain Kennedy Rd S

233	44400	12 Captain Kennedy Rd
234	44500	10 Captain Kennedy Rd S
235	44600	8 Captain Kennedy Rd S
236	44700	6 Captain Kennedy Rd S
237	44800	4 Captain Kennedy Rd S
238	44900	3 Riverview St
239	44950	5 Riverview St
240	45000	7 Riverview St
241	46500	1 Maple Ridge Dr
242	46600	6 Elm St
243	46700	5 Captain Kennedy Rd
244	46800	3 Captain Kennedy Rd N
245	46900	1 Captain Kennedy Rd N
246	47000	2 Elm St
247	47200	5 Elm St
248	47400	3 Elm St
249	48120	39 Maple Ridge Dr
250	48122	37 Maple Ridge Dr
251	48124	35 Maple Ridge Dr
252	48126	33 Maple Ridge Dr
253	48128	31 Maple Ridge Dr
254	48130	29 Maple Ridge Dr
255	48132	27 Maple Ridge Dr
256	48134	25 Maple Ridge Dr
257	48136	23 Maple Ridge Dr
258	48138	21 Maple Ridge Dr
259	48140	19 Maple Ridge Dr
260	48142	17 Maple Ridge Dr
261	48144	15 Maple Ridge Dr
262	48146	13 Maple Ridge Dr
263	48148	11 Maple Ridge Dr
264	48150	9 Maple Ridge Place
265	48152	7 Maple Ridge Place
266	48153	5 Maple Ridge Place
267	48154	7 Elm St
268	48156	5599 No. 9 Hwy E
269	48158	5597 No. 9 Hwy E
270	48160	5595 No. 9 Hwy E
271	48162	36 Maple Ridge Dr
272	48164	34 Maple Ridge Dr
273	48166	32 Maple Ridge Dr
274	48168	30 Maple Ridge Dr
275	48170	28 Maple Ridge Dr
276	48172	26 Maple Ridge Dr
277	48174	24 Maple Ridge Dr
278	48176	22 Maple Ridge Dr
279	48178	20 Maple Ridge Dr

280	48180	18 Maple Ridge Dr
281	48182	16 Maple Ridge Dr
282	48184	14 Maple Ridge Dr
283	48186	12 Maple Ridge Dr
284	48188	10 Maple Ridge Dr
285	48190	8 Maple Ridge Dr
286	48192	6 Maple Ridge Dr
287	48194	4 Maple Ridge Dr
288	48196	2 Maple Ridge Dr
289	48203	3 Maple Ridge Dr
290	48300	101 Hazel Ave
291	48400	103 Hazel Ave
292	48480	109 Hazel Ave
293	48490	107 Hazel Ave
294	48500	105 Hazel Ave
295	49000	5550 No. 9 Hwy W
296	49200	5554 Hwy # 9 W
297	49300	5607 Highway 9
298	49315	16 Praznik Pl
299	49316	18 Praznik Pl
300	49317	20 Praznik Pl
301	49318	17 Praznik Pl
302	49345	5615 5617 No. 9 Hwy E
303	49346	42 Pincherry Lan
304	49347	49 Pincherry Lan
305	49348	15 Praznik Pl
306	49349	11 Praznik Pl
307	49351	9 Praznik Pl
308	49352	7 Praznik Pl
309	49353	5 Praznik Pl
310	49354	3 Praznik Pl
311	49356	14 Praznik Pl
312	49357	12 Praznik Pl
313	49358	10 Praznik Pl
314	49359	8 Praznik Pl
315	49360	6 Praznik Pl
316	49361	4 Praznik Pl
317	49362	24 Maple Cliff Cov
318	49363	22 Maple Cliff Cov
319	49364	20 Maple Cliff Cov
320	49365	18 Maple Cliff Cov
321	49366	16 Maple Cliff Cov
322	49367	14 Maple Cliff Cov
323	49368	12 Maple Cliff Cov
324	49369	10 Maple Cliff Cov
325	49370	8 Maple Cliff Cov
326	49371	6 Maple Cliff Cov

327	49372	4 Maple Cliff Cov
328	49377	18 Hay Ave
329	49378	16 Hay Ave
330	49379	14 Hay Ave
331	49380	12 Hay Ave
332	49381	10 Hay Ave
333	49382	3 Maple Cliff Cov
334	49383	5 Maple Cliff Cov
335	49384	7 Maple Cliff Cov
336	49385	9 Maple Cliff Cov
337	49386	11 Maple Cliff Cov
338	49400	5556 No. 9 Hwy W
339	49500	5558 No. 9 Hwy W
340	50100	5609 No. 9 Hwy E
341	50200	5611 No. 9 Hwy E
342	50300	5613 No. 9 Hwy E
343	50500	5560 No. 9 Hwy W
344	50600	5564 No. 9 Hwy
345	50700	5566 No. 9 Hwy W
346	51402	44 Hay Ave
347	51404	5619 No. 9 Hwy E
348	51406	58 Pincherry Lan
349	51408	59 Pincherry Lan
350	51410	36 Hay Ave
351	51412	34 Hay Ave
352	51414	32 Hay Ave
353	51416	30 Hay Ave
354	51418	28 Hay Ave
355	51420	26 Hay Ave
356	51422	24 Hay Ave
357	51424	22 Hay Ave
358	51426	43 Hay Ave
359	51428	41 Hay Ave
360	51430	39 Hay Ave
361	51432	37 Hay Ave
362	51434	35 Hay Ave
363	51436	33 Hay Ave
364	51438	31 Hay Ave
365	51440	29 Hay Ave
366	51442	27 Hay Ave
367	51444	25 Hay Ave
368	51446	23 Hay Ave
369	51448	21 Hay Ave
370	51450	19 Hay Ave
371	51452	17 Hay Ave
372	51454	15 Hay Ave
373	51456	13 Hay Ave

374	51458	11 Hay Ave
375	51460	9 Hay Ave
376	51462	7 Hay Ave
377	51464	5 Hay Ave
378	51466	3 Hay Ave
379	51600	5623 No. 9 Hwy E
380	51700	5572 No. 9 Hwy W
381	52200	5578 No. 9 Hwy W
382	52296	110 Hay St
383	52300	102 Hay Ave
384	53000	5635 Highway #9 .
385	53100	5639 No. 9 Hwy E
386	53150	5637 No. 9 Hwy E
387	53200	5584 No.9 Hwy
388	53205	107 Hay Ave
389	53210	109 Hay Ave
390	53215	111 Hay Ave
391	53220	115 Hay Ave
392	53225	117 Hay Ave
393	53230	119 Hay Ave
394	200100	5643 No. 9 Hwy E
395	200125	Theodore Rd
396	200130	43 Theodore Rd
397	200135	51 Nicola Dr
398	200140	52 Jonson Dr
399	200200	53 Jonson Dr
400	200214	37 Foxgrove Tr N
401	200215	35 Foxgrove Tr N
402	200216	33 Foxgrove Tr N
403	200217	31 Foxgrove Tr N
404	200218	29 Foxgrove Tr N
405	200219	27 Foxgrove Tr N
406	200220	25 Foxgrove Tr N
407	200221	23 Foxgrove Tr
408	200222	36 Foxgrove Tr S
409	200223	34 Foxgrove Tr S
410	200224	32 Foxgrove Tr S
411	200225	30 Foxgrove Tr S
412	200226	28 Foxgrove Tr S
413	200227	24 Foxgrove Tr S
414	200228	22 Foxgrove Tr S
415	200229	20 Foxgrove Tr S
416	200231	58 Nicola Dr
417	200400	96 Van Mol
418	200500	5647 No. 9 Hwy E
419	200600	
420	200700	502 River Rd

421	201000	59 Theodore Rd
422	201200	5651 No. 9 Hwy E
423	201300	No. 9 Hwy
424	201400	58 Theodore Rd
425	202300	117 Goldstone Rd
426	202500	115 Goldstone Rd
427	202600	113 Goldstone Rd
428	202700	111 Goldstone Rd
429	202800	109 Goldstone Rd
430	202900	107 Goldstone Rd
431	203000	105 Goldstone Rd
432	203100	5600 No. 9 Hwy W
433	203200	5596 No. 9 Hwy W
434	203250	103 Goldstone Rd
435	203700	116 Goldstone Rd
436	203750	118 Goldstone Rd
437	203800	112 Goldstone Rd
438	203900	110 Goldstone Rd
439	204000	108 Goldstone Rd
440	204010	106 Goldstone Rd
441	204100	5594 No. 9 Hwy W
442	204200	5592 No. 9 Hwy W
443	205000	20 Donald Rd E
444	205050	52 Donald Rd E
445	205052	Nicola Dr
446	205090	58 Donald Rd
447	205100	56 Donald Rd E
448	205200	74 Donald Rd E
449	205300	76 Donald Rd E
450	205400	78 Donald Rd E
451	205500	80 Donald Rd E
452	205600	82 Donald Rd E
453	205610	86 Donald Rd E
454	205620	88 Donald Rd E
455	205630	90 Donald Rd E
456	205700	5661 Highway #9 .
457	205900	66 Donald Rd E
458	206000	70 Donald Rd E
459	206100	72 Donald Rd E
460	206200	5657 No. 9 Hwy E
461	206560	8 Camplain Clo
462	206562	110 Donald Rd
463	206564	9 Dakota Cl
464	206566	104 Donald Rd
465	206570	5604 Hwy # 9 . W
466	206572	7 Dakota Cl
467	206574	8 Dakota Cl

468	206576	9 Camplin Cl
469	206578	10 Camplin Close .
470	207180	23 Donald Rd E
471	207190	19 Donald Rd E
472	207200	21 Donald Rd E
473	207300	27 Donald Rd E
474	207400	31 Donald Rd E
475	207500	33 Donald Rd E
476	207550	45 Donald Rd E
477	207560	43 Donald Rd E
478	207570	41 Donald Rd E
479	207580	39 Donald Rd E
480	207590	37 Donald Rd E
481	207600	35 Donald Rd E
482	207700	47 Donald Rd E
483	207800	53 Donald Rd E
484	207900	67 Donald Rd E
485	207905	61 Donald Rd E
486	207910	57 Donald Rd E
487	208000	69 Donald Rd E
488	208100	73 Donald Rd E
489	208150	Donald Rd
490	208200	75 Donald Rd
491	208300	77 Donald Rd E
492	208400	5667 No. 9 Hwy E
493	208500	5665 No. 9 Hwy E
494	208600	5669 No. 9 Hwy E
495	208605	3 Panting Rd
496	208610	4 Panting Rd
497	208700	No. 9 Hwy
498	208720	5616 Highway #9 .
499	208750	105 Donald Rd
500	208800	107 Donald Rd
501	208900	109 Donald Rd
502	209000	117 Donald Rd
503	209005	115 Donald Rd
504	209010	113 Donald Rd
505	209015	111 Donald Rd
506	209350	5624 No. 9 Hwy W
507	209400	17 Donald Rd
508	209450	5673 No. 9 Hwy E
509	209700	9 Donald Rd E
510	209800	5679 No. 9 Hwy E
511	209900	No. 9 Hwy
512	210100	5683 No. 9 Hwy E
513	210150	5 Donald Rd E
514	210200	5632 No. 9 Hwy W

515	210250	5636 No. 9 Hwy W
516	210300	5638 No. 9 Hwy W
517	210425	3 Donald Rd
518	210450	1 Donald Rd
519	210600	5691 No. 9 Hwy E
520	210610	5687 No. 9 Hwy E
521	210900	5695 No. 9 Hwy E
522	211500	5699 Hwy # 9 . E
523	211550	5703 Hwy # 9 . E
524	212200	5705 No. 9 Hwy E
525	212285	45 Mirey Creek Dr
526	212290	47 Mirey Creek Dr
527	212295	49 Mirey Creek Dr
528	212300	5650 No. 9 Hwy W
529	212700	No. 9 Hwy
530	212910	39 Mirey Creek Dr
531	212915	37 Mirey Creek Dr
532	212920	35 Mirey Creek Dr
533	212925	33 Mirey Creek Dr
534	212930	31 Mirey Creek Dr
535	212935	29 Mirey Creek Dr
536	212940	27 Mirey Creek Dr
537	212945	25 Mirey Creek Dr
538	212950	23 Mirey Creek Dr
539	212955	21 Mirey Creek Dr
540	212960	19 Mirey Creek Dr
541	212965	17 Mirey Creek Dr
542	212970	15 Mirey Creek Dr
543	212975	13 Mirey Creek Dr
544	212980	11 Mirey Creek Dr
545	212985	9 Mirey Creek Dr
546	212990	7 Mirey Creek Dr
547	212995	5 Mirey Creek Dr
548	213000	3 Mirey Creek Dr
549	213005	1 Mirey Creek Dr
550	213010	Mirey Creek Dr
551	213015	34 Mirey Creek Dr
552	213020	36 Mirey Creek Dr
553	213025	38 Mirey Creek Dr
554	213030	40 Mirey Creek Dr
555	213035	42 Mirey Creek Dr
556	213040	44 Mirey Creek Dr
557	213045	4 Mirey Creek Dr
558	213050	6 Mirey Creek Dr
559	213055	8 Mirey Creek Dr
560	213060	10 Mirey Creek Dr
561	213065	12 Mirey Creek Dr

562	213070	14 Mirey Creek Dr
563	213075	16 Mirey Creek Dr
564	213080	18 Mirey Crk
565	213085	15 Tanis Cre
566	213090	13 Tanis Cre
567	213095	11 Tanis Cre
568	213100	9 Tanis Cre
569	213105	7 Tanis Cre
570	213110	5 Tanis Cre
571	213115	3 Tanis Cre
572	213120	1 Tanis Cre
573	213130	24 Mirey Creek Dr W
574	213135	26 Mirey Creek Dr
575	213140	28 Mirey Creek Dr
576	213145	30 Mirey Creek Dr
577	213150	4 Tanis Cre
578	213155	6 Tanis Cre
579	213160	8 Tanis Cre
580	213165	10 Tanis Cre
581	213900	No. 9 Hwy
582	52160	Maple Cliff Cov
583	52170	Maple Cliff Cov
584	206568	5610 Highway #9 .
585	29742	22 Miles Pl
586	200270	47 Theodore Rd
587	212600	5709 No 9 Hwy E
588	27298	5519 No 9 Hwy
589	27300	5515 Highway #9 .
590	27302	Walter St.
591	27314	Walter St.
592	214700	No. 9 Hwy
593	215400	2 Stevens Ave E
594	215600	5753 No. 9 Hwy E
595	215700	71 Stevens Ave E
596	215800	69 Stevens Ave E
597	215900	65 Stevens Ave E
598	215950	67 Stevens Ave E
599	216000	63 Stevens Ave E
600	216100	61 Stevens Ave E
601	216300	59 Stevens Ave E
602	216400	57 Stevens Ave E
603	216500	55 Stevens Ave E
604	216600	53 Stevens Ave E
605	216700 51B	Stevens Ave E
606	216800	51 Stevens Ave E
607	216900	49 Stevens Ave E
608	217000	47 Stevens Ave E

609	217100	45 Stevens Ave E
610	217150	43 Stevens Ave
611	217300	41 Stevens Ave E
612	217400	39 Stevens Ave E
613	217600	37 Stevens Ave E
614	217700	35 Stevens Ave E
615	217800	31 Stevens Ave E
616	217900	29 Stevens Ave E
617	218000	27 Stevens Ave E
618	218100	25 Stevens Ave E
619	218200	23 Stevens Ave E
620	218300	21 Stevens Ave E
621	218400	19 Stevens Ave E
622	218500	17 Stevens Ave E
623	218600	15 Stevens Ave E
624	218700	13 Stevens Ave E
625	218800	9 Stevens Ave E
626	218900	7 Stevens Ave
627	219000	608 River Rd
628	219100	5747 Highway # 9 .
629	219200	90 Stevens Ave E
630	219300	88 Stevens Ave E
631	219400	86 Stevens Ave E
632	219500	84 Stevens Ave E
633	219600	82 Stevens Ave E
634	219700	80 Stevens Ave E
635	219800	78 Stevens Ave E
636	219900	76 Stevens Ave E
637	220000	74 Stevens Ave E
638	220100	72 Stevens Ave E
639	220200	70 Stevens Ave E
640	220300	68 Stevens Ave E
641	220400	66 Stevens Ave E
642	220500	64 Stevens Ave E
643	220700	60 Stevens Ave E
644	220800	58 Stevens Ave E
645	220900	56 Stevens Ave E
646	221000	54 Stevens Ave E
647	221100	52 Stevens Ave E
648	221200	50 Stevens Ave E
649	221300	48 Stevens Ave E
650	221400	46 Stevens Ave E
651	221500	44A Stevens Ave E
652	221600	42 Stevens Ave E
653	221700	38 Stevens Ave E
654	221750	40 Stevens Ave E
655	221800	36 Stevens Ave E

656	221900	34 Stevens Ave E
657	222000	32 Stevens Ave E
658	222100	30 Stevens Ave E
659	222300	28 Stevens Ave E
660	222400	24 Stevens Ave E
661	222500	22 Stevens Ave E
662	222600	20 Stevens Ave E
663	222700	18 Stevens Ave E
664	222800	16 Stevens Ave E
665	222900	14 Stevens Ave E
666	222990	12 Stevens Ave E
667	223000	10 Stevens Ave E
668	223100	8 Stevens Ave E
669	223200	6 Stevens Ave E
670	223300	4 Stevens Ave E
671	223600	108 Stevens Ave W
672	223603	106 Stevens Ave W
673	223605	110 Stevens Ave W
674	223610	112 Stevens Ave W
675	223615	114 Stevens Ave W
676	223620	116 Stevens Ave W
677	223625	118 Stevens Ave W
678	223630	120 Stevens Ave W
679	223635	119 Stevens Ave W
680	223640	117 Stevens Ave W
681	223645	115 Stevens Ave W
682	223650	113 Stevens Ave W
683	223655	111 Stevens Ave W
684	223660	109 Stevens Ave W
685	223665	107 Stevens Ave W
686	223850	104 Stevens Ave W
687	224200	102 Lockport Rd
688	224250	104 Lockport Rd
689	224300	106 Lockport Rd
690	224350	108 Lockport Rd
691	224360	110 Lockport Rd
692	224410	112 Lockport Rd
693	224420	114 Lockport Rd
694	224430	116 Lockport Rd
695	224440	118 Lockport Rd
696	224450	120 Lockport Rd
697	224490	105 Stevens Ave W
698	224495	103 Stevens Ave W
699	224500	101 Stevens Ave W
700	225450	100 # 44 Hwy
701	225800	120 Highway #44 .
702	226000	5759 No. 9 Hwy E

703	226300	5761 No. 9 Hwy E
704	226400	5763 No. 9 Hwy E
705	226500	No. 9 Hwy
706	226800	5718 Highway #9 .
707	226835	103 Lockport Rd
708	226840	105 Lockport Rd
709	226845	107 Lockport Rd
710	226850	109 Lockport Rd
711	226855	111 Lockport Rd
712	226860	113 Lockport Rd
713	226865	115 Lockport Rd
714	226870	117 Lockport Rd
715	226875	119 Lockport Rd
716	226885	5722 No. 9 Hwy W
717	227800	5771 No. 9 Hwy E
718	228000	5726 No. 9 Hwy W
719	228500	5779 No. 9 Hwy E
720	228600	5730 Highway # 9 .
721	229000	5783 No. 9 Hwy E
722	229100	5734 No. 9 Hwy W
723	229200	5732 No. 9 Hwy W
724	229598	5787 No. 9 Hwy E
725	229599	5789 No. 9 Hwy E
726	229600	5791 No. 9 Hwy E
727	229601	5793 No. 9 Hwy E
728	230150	5797 No. 9 Hwy E
729	223500	102A Stevens Ave W
730	223400	102 Stevens Ave W
731	223390	5694 Hwy 9
732	27816	344 River Rd
733	27830	338 River Rd
734	30100	374 River Rd
735	51468	480 River Ave
736	215200	5745 No.9 Hwy E
737	49373	474 River Rd